

Groove milling tools · Nutenfräser

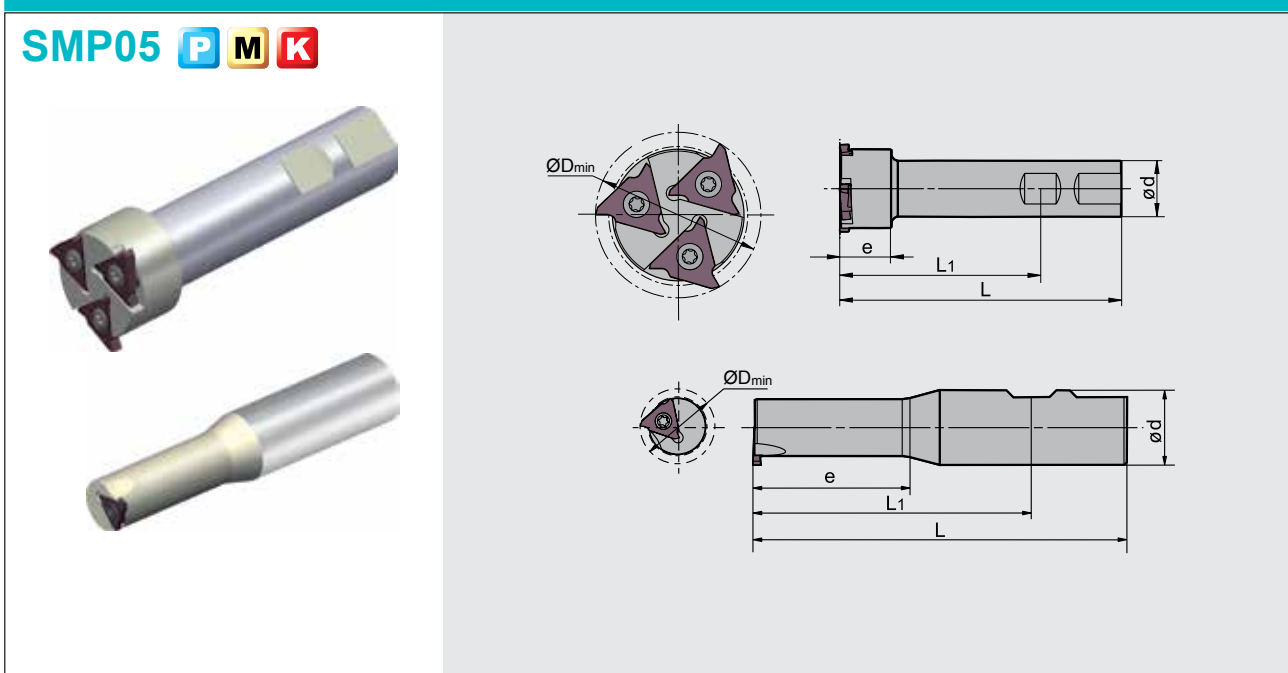

■ Specification of tools · Werkzeug Beschreibung

Type Typ	Stock Lager	Dimensions (mm) Abmessungen					No. of teeth Zähne	Inserts WSP	W(mm)	
		ØD _{min}	ød	e	L ₁	L				
SMP05	-025×3.0-XP25-QC16-01	●	25	25	40	89	125	1	QC16L 110~300	1.10-3.00
	-039×3.0-XP25-QC16-03	●	39	25	23	89	125	3	QC16L 110~300	1.10-3.00
	-044×4.8-XP25-QC22-03	●	44	25	23	89	125	3	QC22L 125~480	1.25-4.8

■ Spare parts · Ersatzteile

Diameter Durchmesser Ø D	Screw Schraube	Wrench Schlüssel
Ø25	I60M3.5×10	WT15IP
Ø39	I60M3.5×10	WT15IP
Ø44	I60M5×13	WT20IP



Applicable tool
Werkzeug

[B11-B18](#)

Tools code key
Werkzeug ISO

[B26-B27](#)

Grade selection guide
Sortenauswahl

[B19-B23](#)

Technical data
Technische Daten

[B215-B220](#)

Milling · Fräsen

Indexable Milling Tools · Wendepplattenfräser

Applicable inserts · Wendeschneidplatten

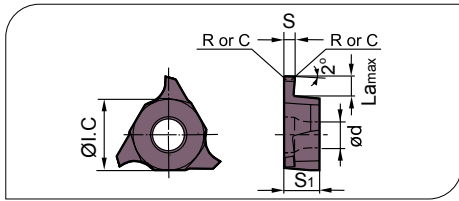

- Ideal Machining Condition / Gute Bearbeitungsbedingungen
- Normal Machining Condition / Normale Bearbeitungsbedingungen
- Unfavorable Machining Condition / Ungünstige Bearbeitungsbedingungen

Workpiece Material / Werkstoffe	P	M	K	N	S	YBC301	YBC302	YBC401	YBM251	YBM253	YBM351	YBD152	YBD252	YBG102	YBG202	YBG205	YBG302	YBG152	YBG252	YNG151	YNG151C	YC30S	YD101	YD201
P Steel / Stahl	●	●	●	●	●	●	●	●	●	●	●	●	●	●	●	●	●	●	●	●	●	●	●	●
M Stainless Steel / Rostfreier Stahl	●	●	●	●	●	●	●	●	●	●	●	●	●	●	●	●	●	●	●	●	●	●	●	●
K Cast iron / Gusseisen			●	●	●																			
N Non-ferrous material / Ne Metalle				●	●																			
S Heat-resistant steel / Warmfester Stahl					●																			

Insert WSP	Type Typ	Dimensions (mm) / Abmessungen						CVD Coating / CVD Beschicht.						PVD Coating / PVD Beschicht.						Cermet Cermet	Carbide uncoat. / unbe. Hartmetall						
		S±0.025	La_max	R/C	ØI.C	S1	ød	YBC301	YBC302	YBC401	YBM251	YBM253	YBM351	YBD152	YBD252	YBG102	YBG202	YBG205	YBG302		YBG152	YBG252	YNG151	YNG151C	YC30S	YD101	YD201
	QC16L110-R01	1.10	2.00	R0.1	9.525	3.18	4.4										○	●									
	QC16L125-R02	1.25	2.00	R0.2	9.525	3.18	4.4										○	●									
	QC16L145-R02	1.45	2.00	R0.2	9.525	3.18	4.4										○	●									
	QC16L150-R02	1.50	2.00	R0.2	9.525	3.18	4.4										○	●									
	QC16L175-R02	1.75	2.00	R0.2	9.525	3.18	4.4										○	●									
	QC16L185-R02	1.85	2.50	R0.2	9.525	3.18	4.4										○	●									
	QC16L200-R02	2.00	2.50	R0.2	9.525	3.18	4.4										○	●									
	QC16L250-R02	2.50	2.50	R0.2	9.525	3.18	4.4										○	●									
	QC16L300-R02	3.00	3.00	R0.2	9.525	3.18	4.4										○	●									

● Ex Stock / ab Lager ○ On demand / auf Anfrage

Applicable inserts · Wendeschneidplatten

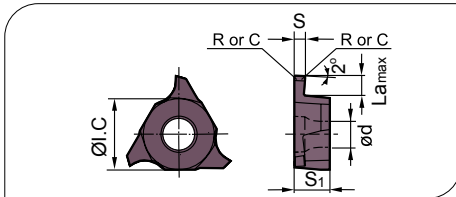

- Ideal Machining Condition
Gute Bearbeitungsbedingungen
- Normal Machining Condition
Normale Bearbeitungsbedingungen
- Unfavorable Machining Condition
Ungünstige Bearbeitungsbedingungen

Workpiece Material Werkstoffe	P	M	K	N	S
Steel Stahl	●	●	●	●	●
Stainless Steel Rostfreier Stahl	●	●	●	●	●
Cast iron Gusseisen	●	●	●	●	●
Non-ferrous material Nichte Metalle	●	●	●	●	●
Heat-resistant steel Warmfester Stahl	●	●	●	●	●

Insert WSP	Type Typ	Dimensions (mm) Abmessungen						CVD Coating CVD Beschicht.						PVD Coating PVD Beschicht.				Cermets Cermets	Carbide uncoat. unbe. Hartmetall							
		S±0.025	Lmax	R/C	ØI.C	S1	ød	YBC301	YBC302	YBC401	YBM251	YBM253	YBM351	YBD152	YBD252	YBG102	YBG202		YBG205	YBG302	YBG152	YBG252	YNG151	YNG151C	YC30S	YD101
	QC22L125-R02	1.25	2.00	R0.2	12.70	4.76	5.5										○	●								
	QC22L145-R02	1.45	2.00	R0.2	12.70	4.76	5.5										○	●								
	QC22L150-R02	1.50	3.50	R0.2	12.70	4.76	5.5										○	●								
	QC22L175-R02	1.75	3.50	R0.2	12.70	4.76	5.5										○	●								
	QC22L185-R02	1.85	3.50	R0.2	12.70	4.76	5.5										○	●								
	QC22L200-R02	2.00	3.50	R0.2	12.70	4.76	5.5										○	●								
	QC22L230-R02	2.30	3.50	R0.2	12.70	4.76	5.5										○	●								
	QC22L250-R03	2.50	4.00	R0.3	12.70	4.76	5.5										○	●								
	QC22L265-R03	2.65	4.00	R0.3	12.70	4.76	5.5										○	●								
	QC22L280-R03	2.80	4.00	R0.3	12.70	4.76	5.5										○	●								
	QC22L300-R03	3.00	4.00	R0.3	12.70	4.76	5.5										○	●								
	QC22L320-R03	3.20	4.00	R0.3	12.70	4.76	5.5										○	●								
	QC22L330-R03	3.30	4.00	R0.3	12.70	4.76	5.5										○	●								
	QC22L350-R03	3.50	5.00	R0.3	12.70	4.76	5.5										○	●								
	QC22L400-R04	4.00	5.00	R0.4	12.70	4.76	5.5										○	○								
	QC22L430-R04	4.30	5.00	R0.4	12.70	4.76	5.5										○	○								
	QC22L450-R04	4.50	5.00	R0.4	12.70	4.76	5.5										○	○								
	QC22L480-R04	4.80	5.00	R0.4	12.70	5.06	5.5										○	○								

Applicable tool
Werkzeug **B11-B18**

Tools code key
Werkzeug ISO **B26-B27**

Grade selection guide
Sortenauswahl **B19-B23**

Technical data
Technische Daten **B215-B220**